



2023 IWWF World Under 21 Waterski Championships June 12-17, 2023

BULLETIN # 2

Updated / New Information in Green

ORGANISERS:

Host Federation - [Federacion Mexicana de Esqui y Wakeboard, AC \(FEMEW\)](#)

Telephone Number: +52 55 59645099

E-Mail Address: otorres@femew.mx

Organising Committee

Event Director: Alvaro Lamadrid

Telephone Number: +52 33 3570 6718

E-Mail Address: alvarolamadrid1@gmail.com

EVENT WEB SITE

<https://iwwf.sport/world-title-events/u21worlds2023/>

THE SITE:

[Boca Laguna](#), a man-made waterski lake with world-class facilities has been the host of the 2009 IWWF World Under 21 Waterski Championships, 2011 Pan American Games, 2012 IWWF World Over 35 Waterski Championships, 2014 Latin American Championships, 2015 IWWF World Waterski Championships and countless Mexican National waterski events.

The venue is located in Chapala, the biggest natural reservoir in Mexico. It has a length of 1.112 km and a depth of 4 m. Boca Laguna is located about 4.5 km from the town of Chapala just off the Chapala-Mezcala highway, and just 34 km away from Guadalajara's International Airport, and 50 km from downtown Guadalajara. Chapala and Ajijic are twin towns located on Chapala's shore and are home to one of the largest expat communities in Mexico. This has created a number of boutique hotels, great restaurants and bars, all in a safe atmosphere for international visitors. Map



IWWF LICENSE

Following an agreement by the IWWF World Congress held in 2019, the IWWF Executive Board approved the establishment of an IWWF License fee from 2021 where athletes wishing to compete in Ranking List / 1 to 6 Star competitions (including IWWF World titled events) in each Sports Division of the IWWF are required to hold an IWWF License. It is requested that Federations ensure that all their athletes hold a valid [IWWF License](#) in order to participate in the 2023 IWWF World Under 21 Waterski Championships.

ENTRY & ADMINISTRATION:

Each Federation shall certify to the Chairman of the IWWF World Waterski Council and to the organising committee, not later than **90 days** before the scheduled start of the first event of the World Championships, its intent to compete via the following link: <http://www.iwsftournament.com/WorldAdmin/>.

Any Federation not meeting this requirement will not be allowed to compete until they pay a fine of US\$200 to the IWWF. To be accepted, the "Intention to Enter" must be accompanied by a deposit amounting to US\$50 for each athlete entered on the form. (For instance: 3 athletes: 3xUS\$50 = US\$150). Each US\$50 will be deducted from the entry fee to be paid later for each athlete. If a Federation subsequently enters less athletes than declared on the ITE the fee of US\$50 paid at that time is forfeited for each missing athlete. **The payment must follow the process described below.**

Any Federation may enter up to two more athletes than originally declared on the "Intention to Enter" form with no penalty, and for which the full entry fee is required. If more than two additional athletes participate, then a levy of US\$50 per additional athlete will be payable in addition to the full entry fee.

Official Entry

The deadline for each Federation to declare, **through EMS**, the names of the members of its team, the events each will enter, the ratings of each skier, as well as the names of the official reserves is **60 days before** the scheduled start of the first event of the World Championships. An entry is considered complete when the Skier's name is registered in EMS and the full Entry Fee Payment has been received. **The entry fee payment must follow the process described below.**

Any skier entered as a Wild Card or Individual is also to be considered as a TEAM reserve.

Any Federation not meeting this requirement will not be allowed to compete until the Federation pays a fine to the IWWF Representative at the Championships, of US\$10 per skier per day after the 60 days deadline for each skier not officially entered.

Team or individual athletes not showing up

In the event a team or individual athletes (for whom their Federation has submitted a competition entry), fail to show up for a competition their entry fee shall still be payable in full, unless a valid written excuse is received by 12 noon of 2 days the day before the start of the competition.

A valid excuse may include a sickness certificate or a certificated injury and should be considered and agreed as valid by the IWWF Representative at the Championships.

The Entry Fee for the event will be **US\$360.00 per participant**, the payment must be made **as per the deadline in the following table**. This Entry Fee includes a levy of US\$30.00 to assist Technical Officials with their travel costs. Payment must be made by bank transfer, to the following account:

CITY BANK

Carlos Roberto Lamadrid Sahagún

Account Number: 42034157182

CITIBANK ABA NUMBER: 322271724

CITIBANK Address: 145 Broadway San Diego, California 92101

FOR INTERNATIONAL WIRE TRANSFERS; SWIFT CODE: CITI US 33

All bank charges are the responsibility of the paying party.

Beginning of Competition	15 June 2023	
90 days before	16 March 2023	Deadline for submitting the Intention to Enter via: http://www.iwsftournament.com/WorldAdmin/
60 days before	15 April 2023	Deadline to enter participants (Team member, Individual, Wild Card) in the EMS

Note:

To be accepted the ITE and the Entry must be accompanied with the relative Fee. After the deadlines set out in the table, the fines set out above will be applied.

All fines have to be paid on-site to the IWWF Representative at the Championships. No skiers will be allowed to start if any due fine is not paid.

REGISTRATION OF PARTICIPANTS (WATERSKI ATHLETES) IN EMS

The registration of the skier participations in EMS has to be done by an EMS Federation Administrator as follows:

1. EMS Federation Administrator has to login to EMS
2. Go to the Competitions menu and set the Competition Code [23IWWF14](#) and the Country "**MEXICO**" in the Search Filters
3. Select the Code **23IWWF14** competition "2023 IWWF World Under 21 Waterski Championships"
4. Scroll down to the Participations section and click the "New participation" button to register the Athletes
5. Enter the Name of the Athlete in the Search box and click on the loop sign to the right
6. Register the Category in Competition, the Event "and the Entry Type.
7. Click on the blue "+Add" button and the participant will be registered.

Repeat Steps 5 to 7 for any additional participants

OFFICIAL FAMILIARIZATION

The last two or three days immediately before the Championships will be reserved and used for Official familiarisation. This will be organised so that each skier who has paid shall be allocated either a set number of passes and/or a certain amount of time at the discretion of the Chief Judge based on the principle that every skier shall receive an equal opportunity for familiarisation.

- Slalom skiers will receive – 4 passes or 6 minutes whichever is less.**
Trick skiers will receive – 2 passes or 5 minutes whichever is less.
Jump skier will receive – 3 passes or 6 minutes whichever is less.

After closure of the registration 60 days before the Championships (please ref. to rule 14.12 for the specific deadline), each entered competitor in the IWWF Event Management System (EMS) will be allocated Official familiarisation time as specified above.

45 days before the scheduled start of the event, the Organiser (in consultation with the Chief Judge, whose decision shall be final) shall announce the Official Familiarisation schedule (including the allowed time).

If a Federation does not want to take part in the Official familiarisation, it must notify the Organisers and the Chief Judge as soon as possible.

The order for familiarisation will be based on the team results from the previous IWWF World Championships with the last placed team athletes going first, and shall be grouped by event, i.e., slalom familiarisation, trick familiarisation and jump familiarisation (by jump height) will be grouped together. Any athlete whose time has not been paid for at least 30 days before the scheduled start of the event, or who is not ready to ski in accordance with the schedule, will lose their official familiarisation time.

Summary Table:

Beginning of Competition	15 June 2023	
60 days before	15 April 2023	Deadline to enter participants (Team member, Individual, Wild Card) in the EMS
45 days before	30 April 2023	Deadline for publishing familiarisation schedule by Organiser.
30 days before	15 May 2023	Deadline for familiarization payment.

The Chief Judge shall have the discretion to change the start time of team's familiarisation based on extraordinary circumstances.

During the Official familiarisation period, the Chief Judge may allocate any available site familiarisation times, but only to skiers who have not already used it or do not have time allocated. Official familiarisation cost is \$360.00 per hour.

Payment should be made to the following:

CITY BANK

Carlos Roberto Lamadrid Sahagún

Account number: 42034157182

CITIBANK ABA Number: 322271724

CITIBANK Address: 145 Broadway San Diego, California 92101

FOR INTERNATIONAL WIRE TRANSFERS; SWIFT CODE: CITI US 33

All bank charges are the responsibility of the paying party

UNOFFICIAL PRACTICE

The deadline to book Unofficial Practice is 26th February 2023, after which some days may be fully booked and time will be very limited.

For unofficial practice, please contact the following:

Alvaro Lamadrid

+523335706718

E-Mail: alvarolamadrid1@gmail.com

OFFICIAL TOW BOAT (ONLY for Official Familiarisation and Competition):

SKI NAUTIQUE 2023



Towboat Speed Control System: Zero Off

DOPING CONTROL

In accordance with the IWWF anti-Doping Rules, drugs controls will be conducted during the competition. By entering this competition, all athletes agree to be subject to doping control. Information about the IWWF Anti-Doping programme, the current IWWF AD Rules and links to the list of banned substances can be accessed on the following link: <https://iwwf.sport/anti-doping-information/>

IWWF SAFE SPORT POLICY AND IWWF SAFEGUARDING REGULATIONS

We take safeguarding extremely seriously and are committed to ensuring that everyone who attends the championships, whether athletes, officials or volunteers are able to operate in a safe environment, free from abuse and the risk of harm. It is a condition of participation that all attendees familiarise themselves and comply with the IWWF Safeguarding Regulations which are available at <https://iwwf.sport/safe-sport-information/>

TRAVEL INSURANCE

The IWWF Bye-Law 16.1 states:

It is the responsibility of each Federation when entering competitors for a World Titled Event to ensure that its competitors are adequately insured for persons for accident, permanent disabilities, death and medical expenses.

FLAGS AND ANTHEMS

Each team must bring an additional flag of their country. (Size approximately 100x150cm) All teams should send (MP3) of their national anthem or confirm the Anthem is on Spotify. If not on Spotify please email MP3 to alvarolamadrid1@gmail.com (Subject line, Your Country/ Anthem)

AIRPORT INFORMATION

The [Miguel Hidalgo y Costilla Guadalajara International Airport \(GDL\)](#) is located 17 kilometers south of the city of Guadalajara, Jalisco, on the Guadalajara-Chapala highway, and 15 kilometers north of Chapala.

Direct Flights from Mexico City

Airlines:

- Aeromexico. • Viva Aerobus
- Volaris

Airlines Flying into [GDL](#):

United	Alaska Airlines	Cathay Pacific
American Airlines	Air Canada	British Airways
Delta	Korean Air	Lufthansa
US Airways	KLM	Qantas
Copa	LAN	Air France

CAR & MINI-BUS RENTALS

Information will be provided in Bulletin 3

VISAS

All participants should check the following link [here](#) order to know if they require need a VISA to enter Mexico. If a VISA is required, the Mexican Waterski and Wakeboard Federation (FEMEW) can provide an invitation letter for the Championships. Alternative, participants can also obtain a letter from their own Federation confirming that they are a member of their country's National Team. It should be noted that the VISA must be obtained at the Embassy or Consulate of Mexico before the participant leaves their country. We advise that the participant allows plenty of time prior to their expected departure to obtain this document.

HOTEL ACCOMODATION

Hotel Name:	HS Hotsson Hotel Chapala Carr. Guadalajara Chapala 8890, 45908 Chapala, Jal., Mexico Phone: +52 376 765 8120	
Room Rate – Single Room	*1,895.00 Mexican Pesos per night (approx USD100.00)	inclusive of Breakfast for one person, WIFI, Taxes & Service Fees
Double Room	*2,201.00 Mexican Pesos per night (approx USD116.00)	inclusive of Breakfast for two people, WIFI, Taxes & Service Fees
Reservations:	Victor Romero: E-Mail: vromero@hotssonsmart.com Tel: +52 3326480576 David Plazola: E-Mail: sdplazola@hotssonsmart.com Tel: +52 3314113160	
Credit Cards Accepted:	All Major Credit Cards	
Hotel Website:	click here	
Booking Deadline:	ASAP	
Distance from Event Venue:	9.9 km (15 minute drive)	
Notes / Comments	Check-In: 3:00 pm / Check-Out: 12:00 pm	

* All in Mexican Pesos

Currency Exchange Rate 8th February 2023: USD1.00 = \$18.94 pesos

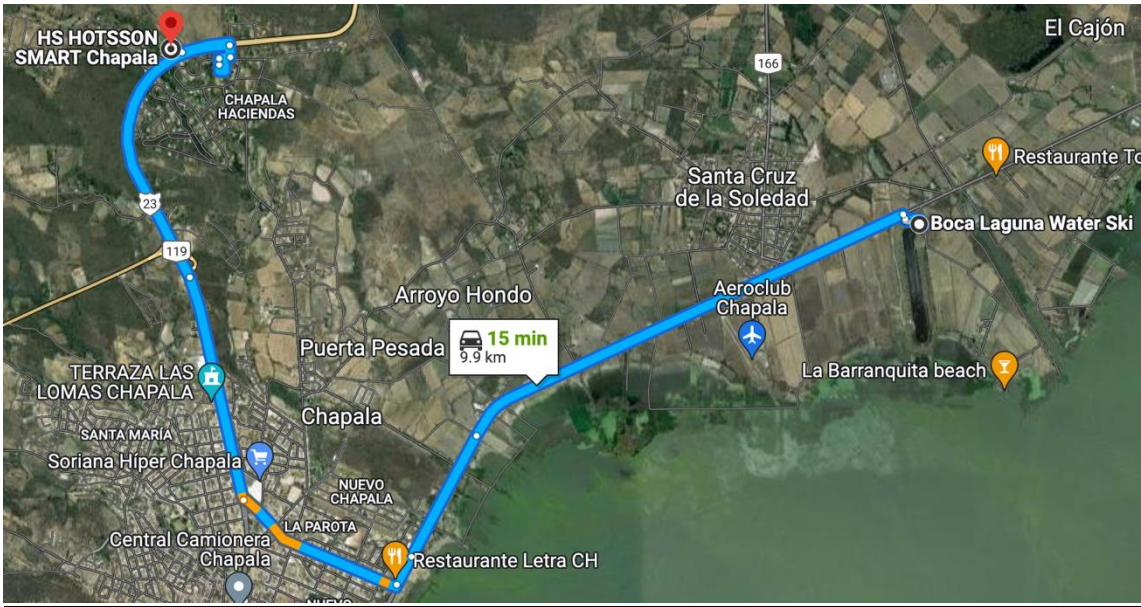

POWER PLUGS & SOCKETS

The standard electricity supply is 110 volts 60 hz (same as the USA).

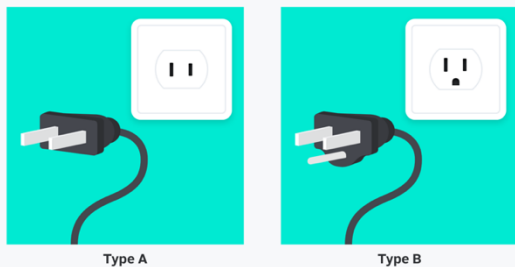

ATHLETE INFORMATION FOR COMMENTATOR & MEDIA

Please request your athletes to log into [IWWF's EMS](#) to fill in / update their profiles (accomplishments, sponsors, **social media handles**, other interesting information in the optional fields, etc. so the event commentator has information easily accessible to communicate to spectators present at the event venue and online via live stream. Athletes should also upload their photos for the media. **IMPORTANT:** To be able to complete/populate their profiles, the Athletes must be EMS USERS, i.e. they must be invited by their respective Federations to become EMS users and have accepted this invitation. Athletes should contact their respective Federations if they are not active / confirmed EMS users. Example – click [here](#)

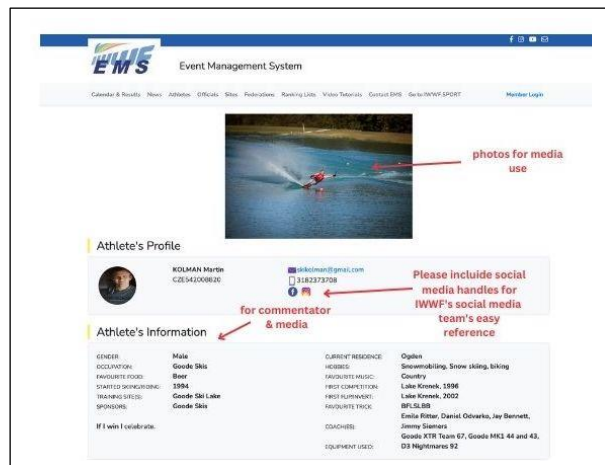

SOCIAL MEDIA

Please use the following hashtags: #u21worlds2023 #iwwf #skinautique
And tag [@IWWFED](#) and [@bocalaguna](#) when posting.

TRANSPORTATION

Transportation from the airport to the official hotel is provided free of charge to Technical Officials, IWWF Waters Council Members, IWWF Executive Board Members, and is available to Athletes at cost. Transportation between the official hotel and the event venue is provided free of charge to Technical Officials, IWWF Waterski Council Members, IWWF Executive Board Members and Athletes.

LUNCHES ON SITE

Lunches on site will be provided free of charge to Athletes, Team Officials, Technical Officials, IWWF Waterski Council Members and IWWF Executive Board Members.

OFFICIAL FUNCTIONS

The Opening Ceremony, Closing Ceremony, and Final Night Banquet are offered free of charge to Athletes, Team Officials, Technical Officials, IWWF Waterski Council Members and IWWF Executive Board Members

TENTATIVE SCHEDULE OF EVENTS

Monday, 12 June 2023	<ul style="list-style-type: none">• Official Familiarisation
Tuesday, 13 June 2023	<ul style="list-style-type: none">• Official Familiarisation
Wednesday, 14 June 2023	<ul style="list-style-type: none">• Preliminary Round• Opening Ceremony (after event)
Thursday, 15 June 2023	<ul style="list-style-type: none">• Preliminary round
Friday, 16 June 2023	<ul style="list-style-type: none">• Preliminary Round• Finals• Individual Medal Ceremonies (after event)
Saturday, 17 June 2023	<ul style="list-style-type: none">• Finals• Individual Medal Ceremonies (after event)• Final Night Banquet & Individual & Team Overall Medal Ceremonies (evening)

WILD CARDS

Each Federation may enter 5 additional single event wild card skiers. The skiers must meet the eligibility rules as defined in 14:13 above. A Federation's Wild Cards cannot be transferred to another Federation. For the purpose of this rule Overall is not considered to be a single event.

TOW ROPES

S-Lines will be used during the event.

- Option 1: The competition series with the gray mainline and the R3 with the white mainline.
- Option 2: The competition series with the white mainline and the new X Series with the silver mainline.

Tow ropes can be purchased through S-Lines' website: slinesusa.com

- Current US dealers are: California Ski Ranch, Swervewatersports.com, Willi's Waterski Schools.
- Adding soon: Wakehouse.com
- Mexico: www.bocalaguna.com, alahua.mx
- Chile: Mirandas Ski School
- Europe: skiboss.se, skinautiquebordeaux.com, slineseurope.com
- Australia: D3 Skis NSW, www.crispwatersports.com.au